

K46AM3  
 Ser. No. 0007129 - 0012756  
 Rev. 2-08-18

ACTUAL PARTS  
 MAY NOT APPEAR  
 AS SHOWN

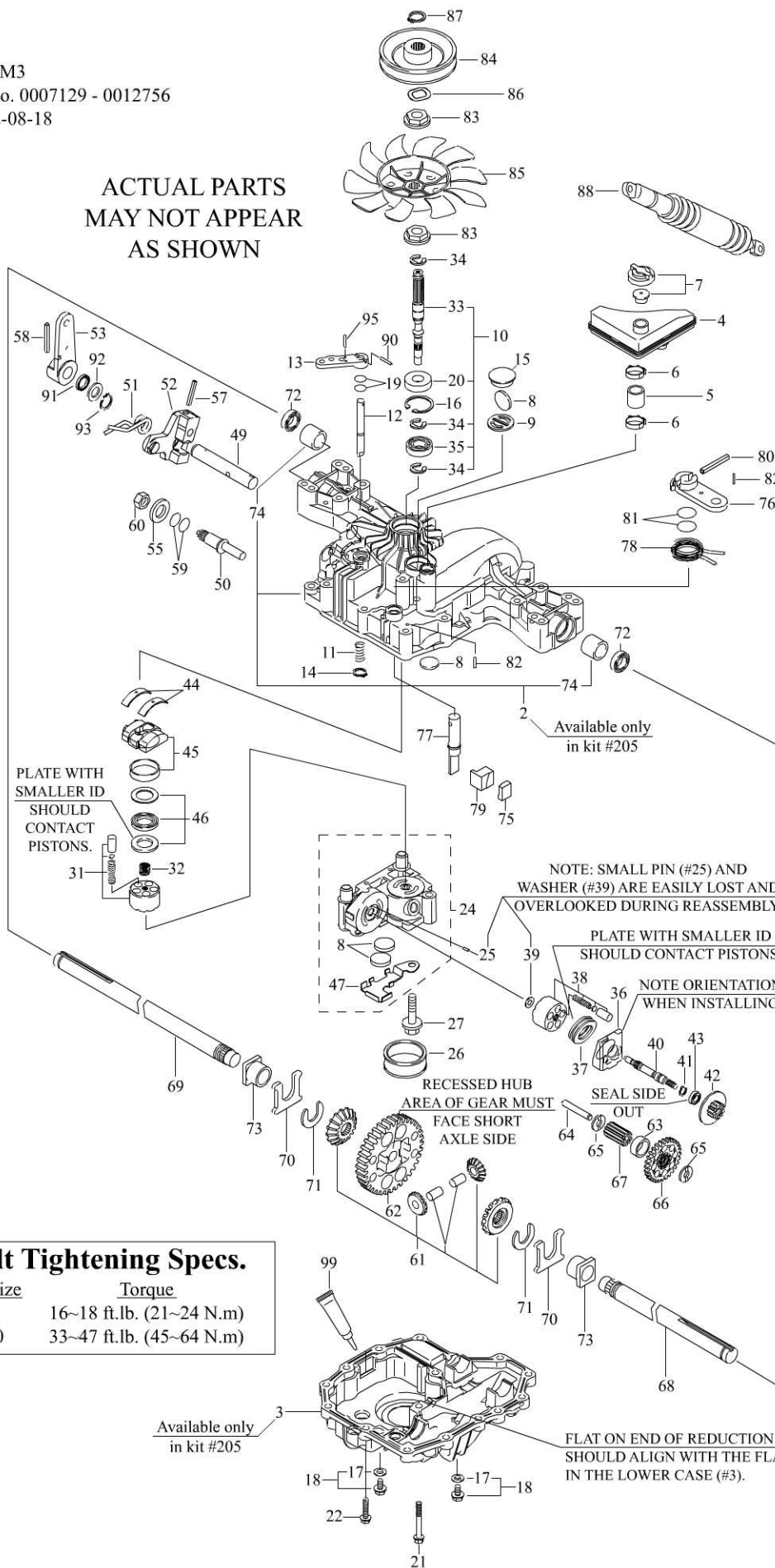

### Bolt Tightening Specs.

Bolt Size	Torque
M8	16~18 ft.lb. (21~24 N.m)
M10	33~47 ft.lb. (45~64 N.m)

#### 1- K46AM Transmission

K46AM Seal Kit	
Kit Includes	
#7	(2) #59
#15	(2) #72
(2) #19	(2) #81
#20	#91
#26	#99
#30	TT-3
All parts may not be used.	

K46AM Repair Kit	
Kit Includes	
#24	#38
#31	
#200 - Seal Kit	
All parts may not be used.	

K46AM Case Kit	
Kit Includes	
#2	#3
Cases must be replaced as a set.	