

ACTUAL PARTS  
MAY NOT APPEAR  
AS SHOWN

ITEM #120 IS AN UPGRADE  
KIT FOR THIS SECTION.  
NOTE ORIENTATION OF  
PARTS WHEN INSTALLING.

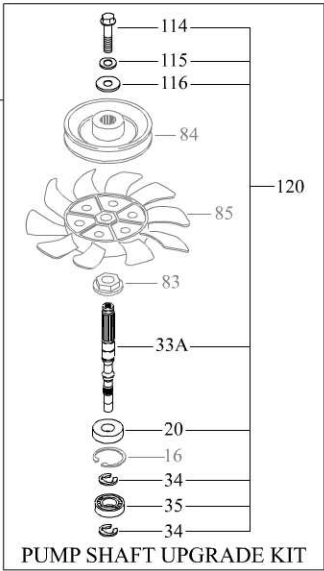

TT-3 TUFF TECH OIL

1 K46AI Transmission

K46AI Seal Kit

Kit Includes

#7	(2) #59
#15	(2) #72
(2) #19	(2) #81
#20	#91
#26	#99
#30	TT-3

All parts may not be used.

K46AI Repair Kit

Kit Includes

#24	#38
#31	
#200 - Seal Kit	

All parts may not be used.

AXLE SHAFT  
REPAIR KIT

Kit Includes

#15	#69
#26	(2) #72
#68	#99
	TT-3

K46AI Case Kit

Kit Includes

#2	#3
----	----

Cases must be replaced as a set.

Bolt Tightening Specs.

Bolt Size	Torque
M8	16~18 ft.lb. (21~24 N.m)
M10	33~47 ft.lb. (45~64 N.m)

Available only  
in kit #205

FLAT ON END OF REDUCTION SHAFT (#64)  
SHOULD ALIGN WITH THE FLAT MOLDED  
IN THE LOWER CASE (#3).