

K46AH
 Ser. No. 0000001 - 0017169
 Rev. 2-05-18

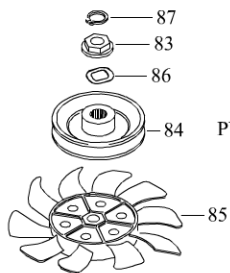

NOTE:
 PULLEY IS SUPPLIED
 BY VEHICLE MFG.
 ON SOME UNITS.

ACTUAL PARTS
 MAY NOT APPEAR
 AS SHOWN



TT-3 TUFF TECH OIL

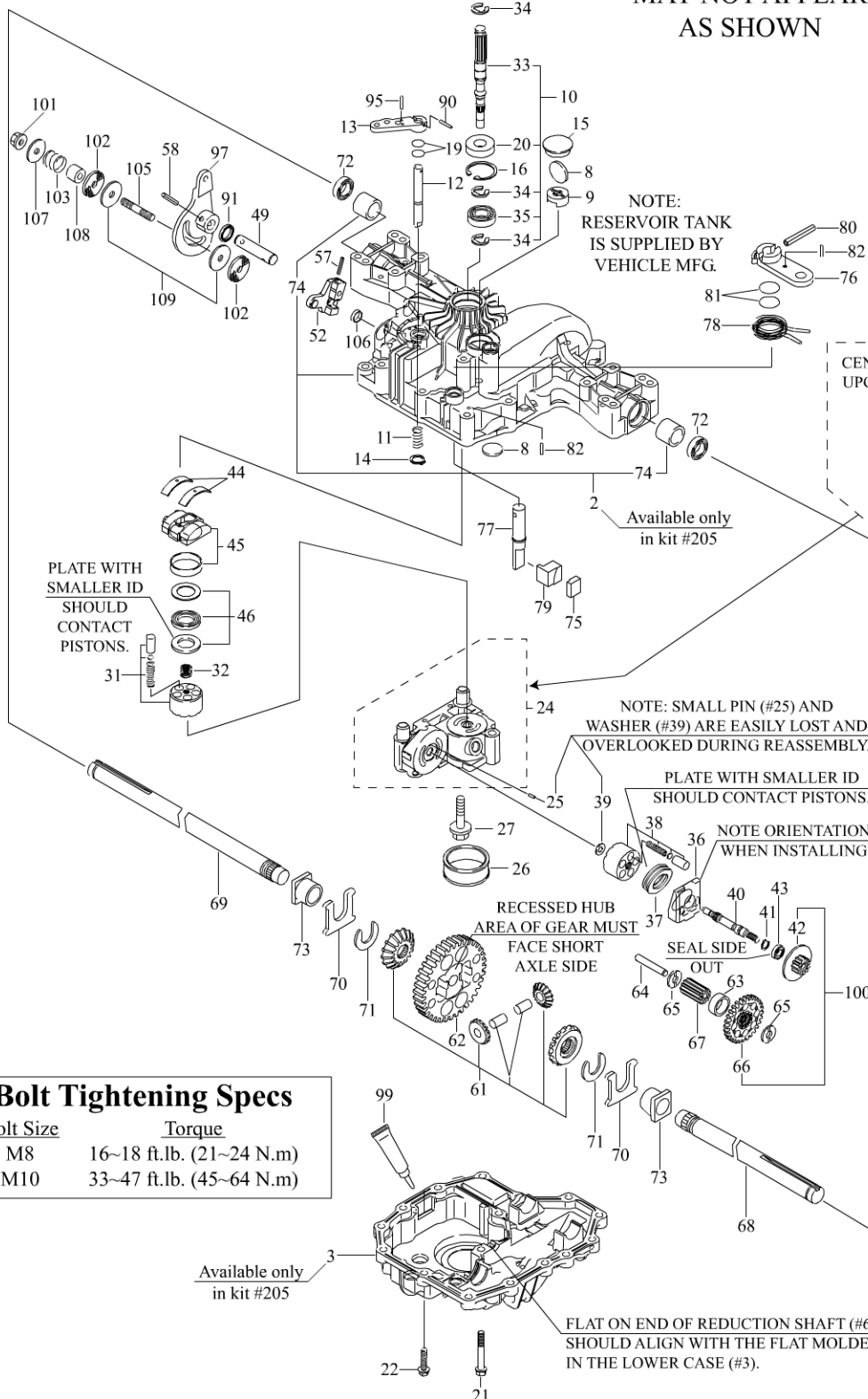
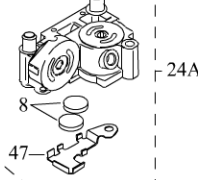

PLATE WITH
 SMALLER ID
 SHOULD
 CONTACT
 PISTONS.

CENTER CASE
 UPGRADE KIT



Available only
 in kit #205

1 K46AH Transmission

K46AH Seal Kit

Kit Includes

#7	(2) #59
#15	(2) #72
(2) #19	(2) #81
#20	#91
#26	#99
#30	TT-3

All parts may not be used.

K46AH Repair Kit

Kit Includes

#24A	#38
#31	
#200 - Seal Kit	

All parts may not be used.

AXLE SHAFT REPAIR KIT

Kit Includes

#15	#69
#26	(2) #72
#68	#99
	TT-3

K46AH Case Kit

Kit Includes

#2	#3
----	----

Cases must be replaced as a set.

Bolt Tightening Specs

Bolt Size	Torque
M8	16~18 ft.lb. (21~24 N.m)
M10	33~47 ft.lb. (45~64 N.m)

Available only
 in kit #205

FLAT ON END OF REDUCTION SHAFT (#64)
 SHOULD ALIGN WITH THE FLAT MOLDED
 IN THE LOWER CASE (#3).

NOTE: SMALL PIN (#25) AND
 WASHER (#39) ARE EASILY LOST AND
 OVERLOOKED DURING REASSEMBLY.

PLATE WITH SMALLER ID
 SHOULD CONTACT PISTONS.

NOTE ORIENTATION
 WHEN INSTALLING

RECESSED HUB
 AREA OF GEAR MUST
 FACE SHORT
 AXLE SIDE

SEAL SIDE
 OUT