

ACTUAL PARTS  
 MAY NOT APPEAR  
 AS SHOWN

### Bolt Tightening Specs.

Bolt Size	Torque
M8	16~18 ft.lb. (21~24 N.m)
M10	33~47 ft.lb. (45~64 N.m)



TT-3 TUFF TECH OIL

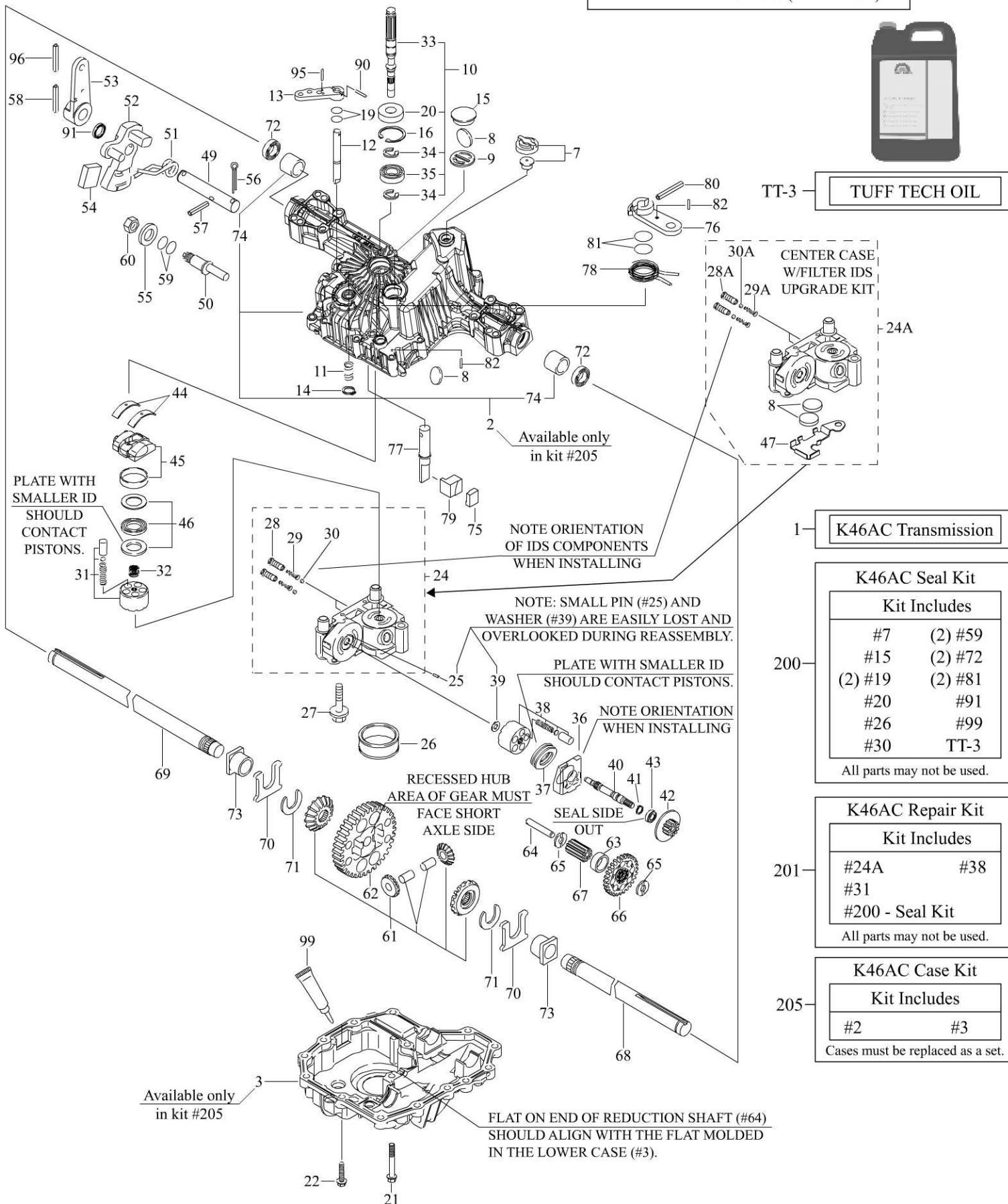

CENTER CASE  
 W/FILTER IDS  
 UPGRADE KIT

24A

1- K46AC Transmission

#### K46AC Seal Kit

##### Kit Includes

#7	(2) #59
#15	(2) #72
(2) #19	(2) #81
#20	#91
#26	#99
#30	TT-3

All parts may not be used.

#### K46AC Repair Kit

##### Kit Includes

#24A	#38
#31	
#200 - Seal Kit	

All parts may not be used.

#### K46AC Case Kit

##### Kit Includes

#2	#3
----	----

Cases must be replaced as a set.